

KEY:

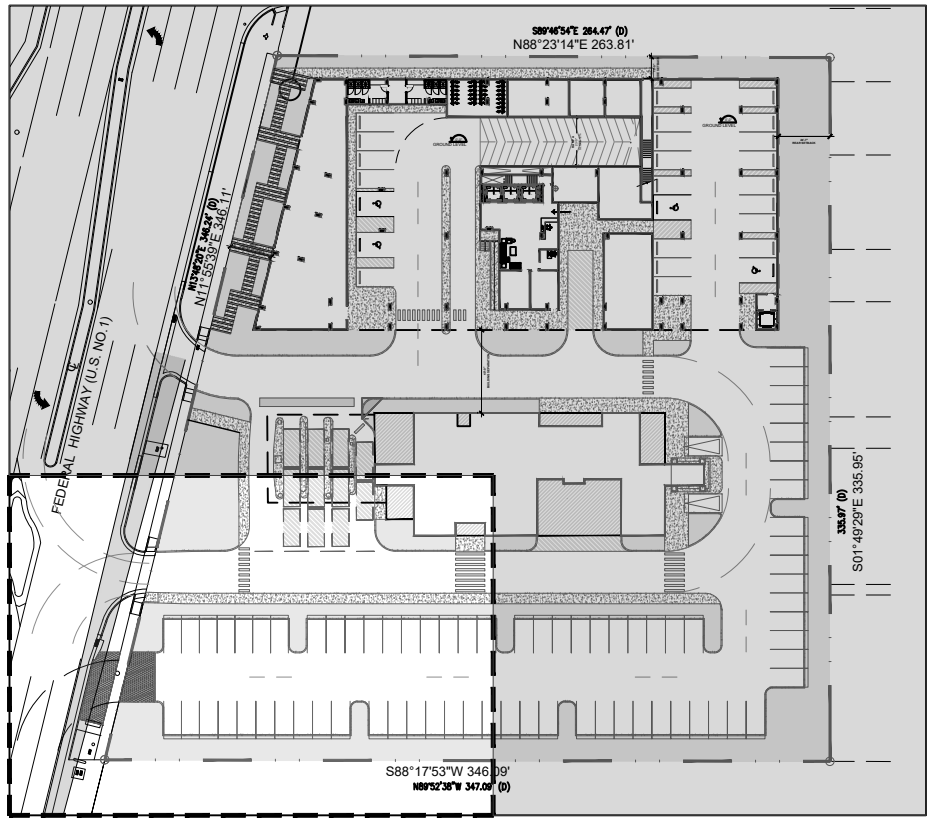

absolute-idea.com
CANAL PARK
3323 NE 163rd Street, Suite 200 North Miami Beach, FL 33160
305.792.0015 305.931.0279 info@absolute-idea.com

SEAL
KEN GARDNER
FLA 1569
TO THE BEST OF MY KNOWLEDGE, THE PLANS AND SPECIFICATIONS COMPLY WITH THE CITY OF MIAMI'S REQUIREMENTS FOR THE PROJECT AND THE PROFESSIONAL SEAL IS VALID FOR THE PROJECT AND THE PROFESSIONAL SEAL IS VALID FOR THE PROJECT AND THE PROFESSIONAL SEAL IS VALID FOR THE PROJECT.

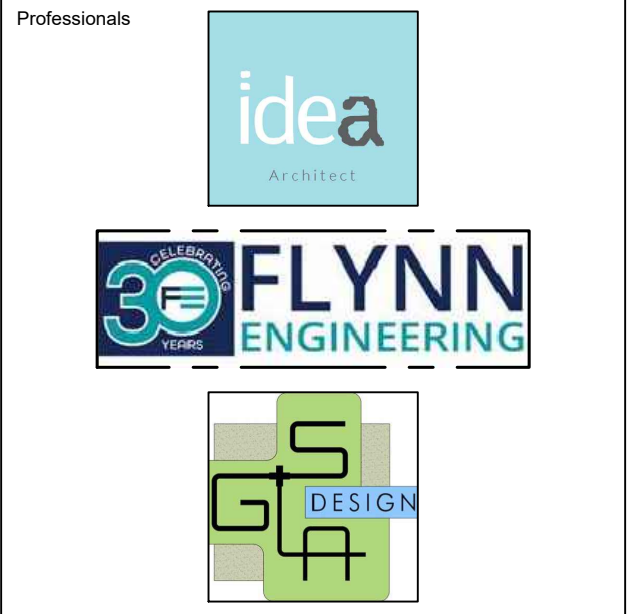

REV.	DATE	DESCRIPTION
01	XX-XX-2024	D.R.C SUBMITAL

ALL MEASUREMENTS MUST BE VERIFIED BEFORE BEGINNING THE WORKS. NO MEASUREMENTS ARE TO BE SCALED DIRECTLY FROM THIS DRAWING.

Key section
PROGRESS SET

Client
VERA FUND
NICK POLYUSHKIN
& YURI KHARITONENKOV
TEL: 305.833.3303

Project
1600 S FEDERAL HIGHWAY (MIXED-USE PROJECT)
1600 SOUTH FEDERAL HIGHWAY,
POMPAHO BEACH, FL 33062

Title	
PLANTING PLAN GROUND FLOOR	
Drawn GSLA	Field LANDSCAPE ARCH
Scale as shown	Scale as shown
Date 10-09-2024	Date 10-09-2024
Project Manager PZB	Dwg. no. L-203
Project PZ24-12000027 11/19/2025 24-838	

PZB
PZ24- 12000027
12/17/2025

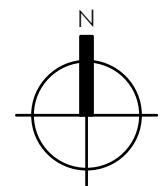

PLANTING PLAN - GROUND FLOOR

SCALE: 1" = 10'